

GAS SOLENOID VALVE

가스 필터

燃气过滤器
GAS FILTER



According to Pressure Equipment Directive 97/23/EC
Rating : Class I , 1000mbar, -20~60°C

HGF

2115
2120
2125

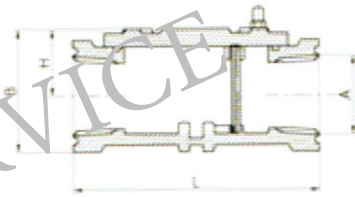
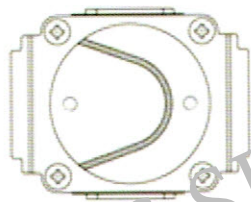

HGF

2140
2150

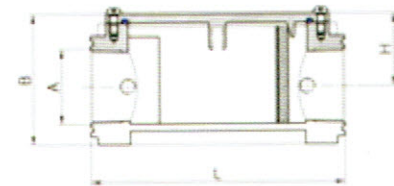
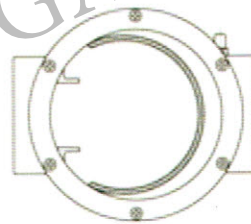

HGF

2150F
2165F
2180F
21100F

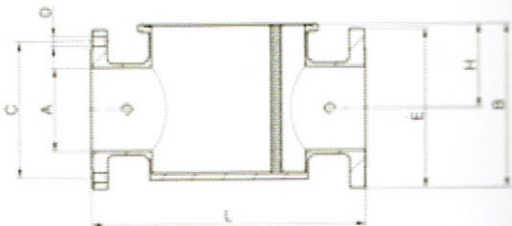
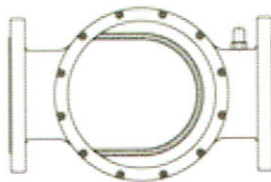

※ Specification of the products are subject to change without prior notice for quality improvement.

치수 | 尺寸 | DIMENSIONS

The Directly Fast Opening and Fast Closing Type

| MODEL | A | B | C | D | E | H | L | 무게 重量 Weight (Kg) |
|-------------------|---------|-----|-----|------|-----|-----|-----|----------------------|
| HGF 2115 (15A) | Rp1/2 | 65 | - | - | - | 40 | 110 | 0.65 |
| HGF 2120 (20A) | Rp3/4 | 65 | - | - | - | 40 | 110 | 0.62 |
| HGF 2125 (25A) | Rp1 | 75 | - | - | - | 40 | 110 | 0.63 |
| HGF 2140 (40A) | Rp1 1/2 | 85 | - | - | - | 48 | 160 | 1.24 |
| HGF 2150 (50A) | Rp2 | 85 | - | - | - | 48 | 160 | 1.31 |
| HGF 2150F (50A) | DN50 | 149 | 125 | 4x18 | 160 | 70 | 215 | 3.47 |
| HGF 2165F (65A) | DN65 | 146 | 145 | 4x18 | 180 | 57 | 270 | 5.29 |
| HGF 2180F (80A) | DN80 | 157 | 160 | 8x18 | 194 | 97 | 313 | 6.06 |
| HGF 21100F (100A) | DN100 | 188 | 180 | 8x18 | 216 | 108 | 316 | 8.81 |
| HGF 21150F (150A) | DN150 | 304 | 240 | 4x23 | 287 | 160 | 491 | 19.86 |

사양 | 规格 | SPECIFICATION

| | | |
|---|--|----------|
| 나사형 연결 螺纹连接 Threaded connections | (Rp) | ISO 7/1 |
| 후렌지형 연결 法兰连接 Flanged connections | (DN) | ISO 7005 |
| 최대 투입 압력 最大投入压力 Maximum inlet pressure | 6bar | |
| 주위 온도 周围温度 Ambient temperature | -15°C ~ 60°C | |
| 사용 가스 适用燃气 Working gas | 도시가스, 천연가스, 메탄가스, 공기 城市煤气, 天然气, 沼气, 空气 Town gas, Natural gas, Methane gas, Air | |

재질 | 材质 | Materials

| | |
|-------------------|--|
| 씰 密封件 Seals | NBR |
| 하우징 外壳 Housing | Aluminium cast |
| 필터 过滤网 Filter | 부직포 & 알루미늄 망 无纺布 & 铝网 Nonwoven polypropylene fabric (≤ 50µm) & Aluminium mesh 부직포 & PVC 카트리지 无纺布 & PVC 固定架 Nonwoven polypropylene fabric (≤ 50µm) & PVC Cartridge |